

enea

landscape architecture



Enzo Enea at the Enea Tree Museum, Rapperswil-Jona, Switzerland @Roland Tännler

PRESS RELEASE

ENEAA at 50

To celebrate their 50th anniversary this year, Enea has embarked on projects to show how landscape design can confront the urgent challenge of climate change and teach ‘green skills’ to future generations

2023 marks the 50th anniversary of Enea, a global landscape architecture firm with offices in Zurich, New York, Miami and Milan, that began in 1973 as a small family business manufacturing and importing Italian terracotta and stone into Switzerland. Twenty years later the second generation of his Italian family to run the business, the landscape architect Enzo Enea grew up in gardens, which ignited his passion for the power and beauty of green space to enhance our world and wellbeing. This sensitivity to the natural world inspired Enea to train both as an engineer in Switzerland and a landscape architect in the UK, combining the art and science of gardening to grow Enea into a ‘one-stop-shop’

for landscape design with a strong environmental ethos. Today Enea employs over 240 employees, including a tree scout; the grounds of its HQ in Rapperswil-Jona outside Zurich are home to a nursery for mature trees, a pot gallery, carpentry workshops, a showroom and the world's only Tree Museum.

In its 50th year, Enea is proud of its achievements, its award-winning international projects and collaborations with renowned architects such as David Chipperfield, Herzog and de Meuron, Zaha Hadid, Tadao Ando, Bjarke Ingels and Sou Fujimoto, among others. However, as the consequences of climate change increasingly impact the entire planet, Enea views its task as urgent and is more committed than ever to using landscape design to combat climate change.

Enzo Enea comments:

Today the most urgent challenge our world faces is climate change, and landscape design is a powerful tool to fight it. I have always believed that if we save trees, we can save ourselves and the planet. We need to think about design from the outside in, to integrate landscape design into architectural schemes. A green space is not just 'a pretty face', it is not decoration or an extra; green space is essential, particularly in the urban context and climate crisis of today. Trees and green planting make a scientifically proven difference to lowering temperatures, cleaning the air, improving drainage and soil quality and increasing biodiversity, thus reducing carbon emissions and energy costs. Today, as these ideas are becoming more mainstream, our goal is to continue to show people – not tell them – about the power of trees and green space in everything we do.

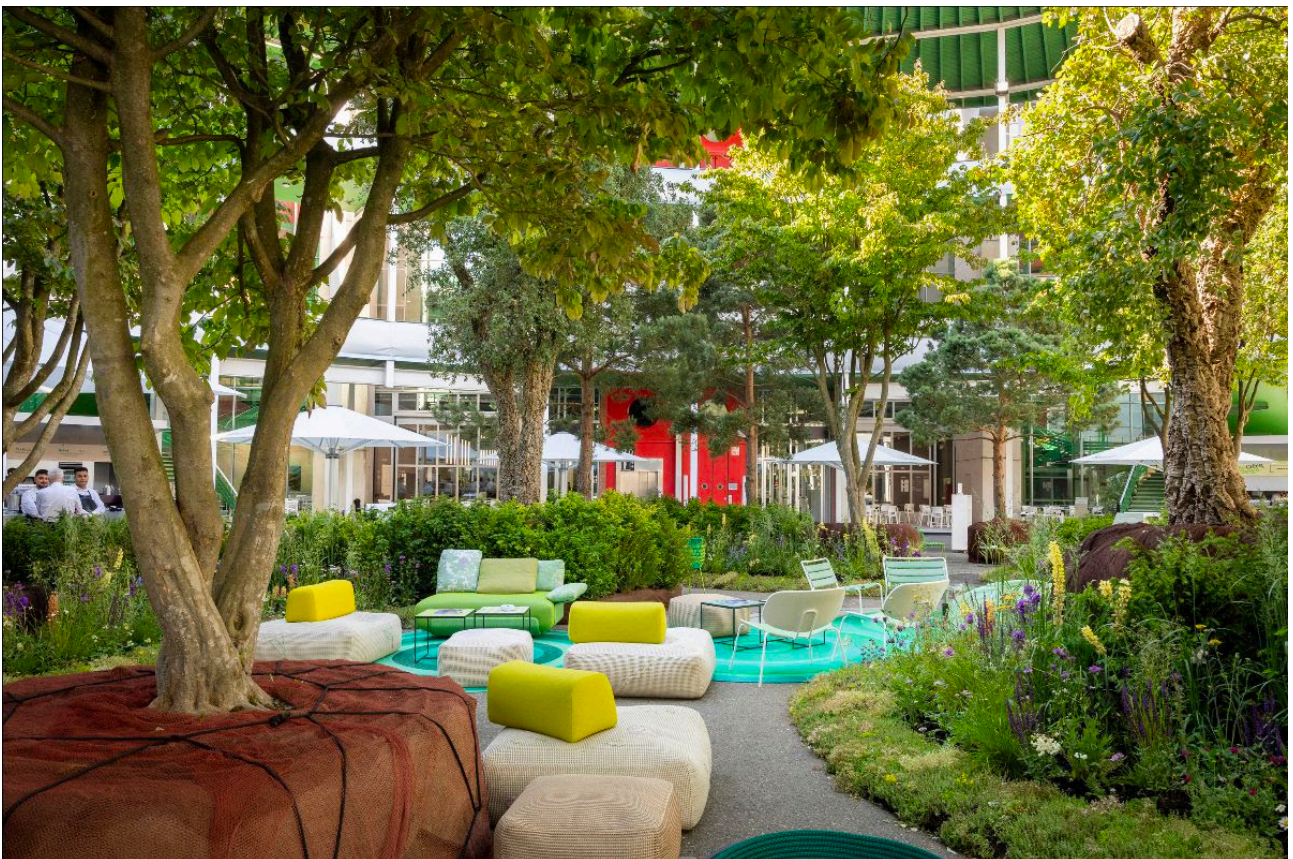

Enea's Treetopia at the Rundhof courtyard, Messe Basel, 2023

While the [Enea Tree Museum](#), founded in 2010, continues to represent the firm's ethos by displaying mature trees rescued from demolition alongside contemporary sculpture with a strong environmental message and belief in the crucial role that trees play to our planet, two 50th anniversary projects in particular reflect Enea's climate focussed mission: [Treetopia at Art Basel](#) in June and the announcement of a future 'Enea Academy' in collaboration with the firm's neighbours and landladies, the Mariazell Convent on Lake Zurich among other project partners. In addition, Enea continues to invest in scientific research and to collaborate with OST Eastern Switzerland University of Applied Sciences to study the microclimates created by the diverse trees planted in its grounds.



Sister Andrea, Abbess Monika of Kloster Mariazell and Enzo Enea with the low-maintenance garden he designed for the nuns in the background © Beat Schweizer, Financial Times

This year Enea created *Treetopia* at Art Basel (13-18 June, 2023) – a forest of the future planted in the concrete central courtyard of the Messe Basel to show how by saving trees we can save ourselves – a vision Enzo Enea presents in the film of the project.

[Click here to watch the video for Treetopia at the Rundhof courtyard, Messe Basel, 2023](#)

Enea installed digital thermometers throughout the courtyard that measured the average temperature under the trees as five degrees Celsius lower than that under the adjacent umbrellas. In addition, the understory planting around the trees increased biodiversity in

this urban space, introducing bees and butterflies in the enclosed space where previously there were none. The unusual combination of mature trees – both hardy Alpine and Mediterranean – demonstrated the type of climate resilient trees that can survive and thrive in Switzerland in the next 20 years as the climate warms. As Enea commented, ‘We don’t have time to wait 20 years – the growing time of a tree – we need to plan and plant for the future now.’ Most importantly, visitors loved *Treetopia* – the garden ‘rooms’ and the ‘benches’ on the covered tree roots became a destination in the middle of the fair and were constantly filled every day of the event, creating a vibrant, verdant space for networking and relaxation.

To further discussion on climate change and create a deeper connection with art, Enea hosted a VIP panel discussion during Art Basel with artist Otobong Nkanga, whose work foregrounds ecological themes, and Vitra Design Museum curator Viviane Stappmans, whose ‘Garden Futures’ exhibition engages with gardens’ impact on society. The talk [‘From the Ground up: Can Art and Design Combat Climate Change?’](#) attracted over 400 views on the live stream, as well as an engaged live audience of curators, gallerists, collectors and press.

[Click here to watch the video of the talk at Art Basel, June 2023](#)

In addition, at their 50th anniversary celebration earlier this month, Enea announced that they will be creating an ‘Enea Academy’ to teach ‘green skills’ to future generations, in collaboration with their neighbours at the Mariazell Convent on Lake Zurich, across the road from the Enea HQ. Enea believes that training young people about working with nature and building careers connected to protecting the planet is essential in an age of increasing digitalisation and climate change. In a feature [article](#) in the FT *How to Spend it Magazine*, Enea discussed his Tree Museum and his close relationship to the land and the nuns of the Mariazell Convent, who share his commitment to protecting and caring for the natural environment. Enea is also working with the Mariazell Convent and SBW Haus des Lernens and other partners to transform a disused convent school into an innovative educational space to teach a pioneering curriculum of ‘future skills’ to young people.

Beyond these 50th anniversary projects, Enea continues to create landscapes around the world – each of which starts with identifying the ‘genius loci’ or spirit of the place to ensure every garden reflects and responds to its local environment, climate, light and natural conditions. Enea’s in-depth research into local climate, soil, plants, urban context and cultural traditions enables it to be one of the only landscape architecture firms to design gardens world-wide that integrate into their environment and combat climate change. In addition to private commissions, forthcoming global projects include a ‘secret’ garden alongside New York’s Highline as part of the One Highline building by Bjarke Ingels; a vast Turkish garden on the shores of the Bosphorus for the new Peninsula Istanbul; flowering walls and mature trees in the courtyard of the new Peninsula London; flexible landscaping and roofgardens at Rockefeller Center, New York; a windswept island garden for the new Lanserhof Sylt spa in the North Sea; hacienda gardens for the historic site of the new Four Seasons in Cartagena; South America’s largest garden masterplan turning a brown-field site into a new district of Sao Paulo and landscapes in Miami and Hong Kong that create green spaces on roofs and walls as well as in the ground.

EDITORS NOTES

Press

For press information and interviews with Enzo Enea, please contact:

Sarah Greenberg, Evergreen Arts

sgreenberg@evergreen-arts.com

+44 (0)7866543242

For images, please contact: ppanagopoulos@evergreen-arts.com

Further Information

For a scientific report on how green planting can reduce climate change, please see the following paper published by the Italian National Agency for New Technologies, Energy and Sustainable Economic Development (ENEA), published 14 July 2022

ENEA Report "[Plant Ecosystems for the Ecological Regeneration of Cities](#)"

Press Release: [‘Treetopia’ at Art Basel](#)

Panel Discussion at Art Basel, 14 June, 2023

[‘From the Ground Up: Can Art and Design combat Climate Change?’](#)

Financial Times HTSI Magazine [article](#) 2 June, 2023

Press on ‘Treetopia’ at Art Basel, June 2023

The Art Newspaper, Art Basel daily paper, 14 June, 2023

[Le Quotidien de l' Art](#)

[Le Journal des Arts](#)

[Ta Nea](#)

About Enea Landscape Architecture

Enea is an international landscape architecture and horticulture company, founded in 1973, with offices in Zurich, New York, Miami and Milan. Led by Enzo Enea, the second generation of his family to work in this field, the award-winning firm is known for preserving and designing with mature trees and is committed to creating sustainable landscape design that positively influences the local microclimates and counteracts the effects of climate change. The firm collaborates with leading international architects and creates landscapes on a range of scales, from private residences to hotels, real estate developments, parks and masterplans. Enea's 240 employees include interdisciplinary professionals with expertise in landscape architecture, interior design, technical planning, engineering, construction and botany. Since 2010, Enea's unique [Tree Museum](#), which presents mature trees rescued from demolition alongside contemporary sculpture at its headquarters outside Zurich in Rapperswil-Jona, has demonstrated the Enea ethos of combining landscape, architecture, art and design in sustainable ways. The firm's apprenticeship program and tree nursery cultivate the landscape professionals of the future with these values.

enea.ch

EVERGREEN ARTS

KEEP YOUR STORY GROWING...